

1031652 | Carbide rotary burr Cylindrical, rounded, Normal teeth Chip-breaker D shaped TECHNIC (Hanging box)

High-performance rotary burr that can withstand the majority of metals and composite metals. Teeth with chip-breakers guaranteed an excellent surface condition and ease of use.



- Especially for high-strength steels, stainless steels and cast irons
- Especially for weld bead
- Excellent surface finish
- Superior long life

- Cylindrical shank
- Chip breaker teeth
- Carbide head



Machine



Application

K	M	P 1	S
K- Ferrous Cast iron with Short Chips	M- Stainless steels	P1- Unrealized steels	S- Super Refractory Alloys

Features



Properties and benefits

- + Cylindrical shank: the diameter of the shank is equal to the diameter of the tip. ➡ Enables versatile use on portable electrical tools and CNC machine tools.
- + Chip-breaking teeth: teeth designed for their high versatility, diamond cutting for the excellent breaking up of chips. ➡ Enables the effective filing of the majority of metals, excellent chip breaking, and neat surface conditions.
- + Tungsten carbide head: ground in a grade of carbide especially suited for high rotation speeds. ➡ Enables an excellent throughout rate and very high resistance to wear, suitable for very high rotation speeds in the majority of metals.

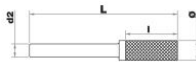

Item number	M3 EAN (13 digits)	M3 Cutter diameter	Handle diameter or CM	Total length	Trimmed length	Number of teeth
10316520600	3221910837280	6	6	50	16	
10316520800	3221910837297	8	6	65	20	
10316521000	3221910837303	10	6	65	20	
10316521200	3221910837310	12	6	70	25	